

SB-101/1

- OMNIDIRECTIONAL
- VERTICALLY POLARIZED
- EXTREME MARINE ENVIRONMENT

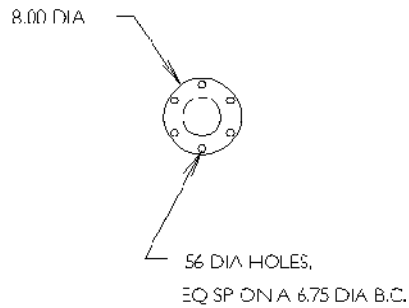
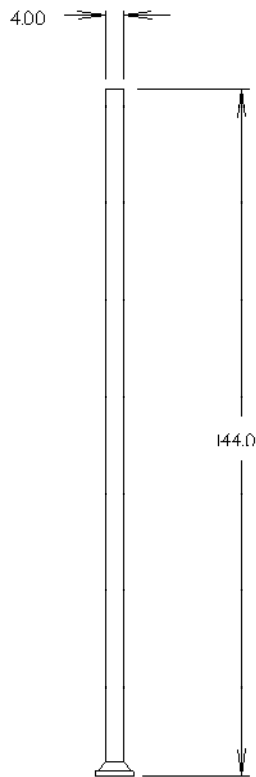

Applications

The SB-101/1 is a VHF shipboard antenna capable of transmitting up to 800 watts power between 30-88 MHz. The antenna provides vertically polarized, omnidirectional coverage over the specified frequency range. The antenna is enclosed in a fiberglass housing, making it suitable for use in the extreme marine shipboard environment.

Features

The SB-101/1 VHF shipboard antenna will withstand the shipboard marine environment. The lightweight element construction is secured inside the housing and damps all vibration frequencies specified in MIL-STD-167, Type I vibration. The SB-101 withstands the shock loads

as specified in MIL-S-901C for Grade A shock. Military designation is AS-3226.



SPECIFICATIONS

Frequency	30-88 MHz	Dust (fine sand)	Test per MIL-STD-810 Method 510.2
Polarization	Vertical	Shock	MIL-S-901C, Grade A, Class I
Impedance	50 Ohms unbalanced	Vibration	MIL-STD-167-1, Type I
VSWR	3.5:1 maximum	Humidity	0 to 100%
Horizon Gain	0 dBi	Wind	100 knots
Azimuth Coverage	Omnidirectional	Ice	4.5 psf on all exposed surfaces
Elevation Coverage	Sinusoidal pattern with max at horizon	Salt Fog (spray)	Withstands 100 hrs test
Half-Power Beamwidth	70°	Height	144 inches
Power Handling Capacity	800 W Avg	Housing Diameter	4 inches
Input Connector	Type "N"	Base	8.0 inches dia.
Temperature Range		Mounting	1/2-inch bolts on a 6.75 inch bolt circle
Operating	-54°C to +65°	Weight	35 lbs
Non-Operating	-62°C to +71°C		